

Multi Service Distribution Board

J type Vertical 24 way, 1 and 2 J, 630A rated

Overview and Presentation

Mild steel wall mounting distribution boards for 3 phase systems configurable with either a single incoming bank of triple pole J type slotted tag fuses or with an additional outgoing bank of triple pole J type fuses for mixed developments requiring a split supply greater than 100A.



1 J version (RH supply)

Features

- Multi-tier outgoing fuse ways provide increased space for cabling
- Factory options include;
 - Left or right hand incoming supply
 - Single or twin bank of triple pole J type fuse links
 - 4 core incoming / outgoing cable kit
 - N/E bar located at top or bottom of enclosure to suit top or bottom entry options
- Site configurable for CNE or SNE cable systems
- M12 fixings for incoming connections and internal busbar links
- Pre-drilled removable gland plate fitted with closed cell foam sealing gasket
- Removable double doors to facilitate fitment in shallow riser cupboards
- Accept up to 300mm² 3 or 4 core aluminium or copper conductors
- Optional glanding kit for different cable types e.g. copper screened, aluminium or steel wire armoured

Note: The equipment described on this data sheet must be installed by suitably qualified personnel according to applicable Local / National Wiring regulations currently in force.

Low Voltage - Cut Outs

Enclosure specification

- Oven-cured epoxy powder coated finish with a minimum thickness of 50 microns
- Standard colour Admiralty grey to BS 381c, shade No 632
- Two stage padlockable double doors enabling independent access to outgoing 100A fuse ways or Distribution Network Operator (DNO) access to incoming J type fuses
- Quick release spring loaded hinge pins permit rapid door removal for improved access
- Overall 250mm depth enables installation in confined spaces
- Two external M12 earth studs

Internal equipment

- Operator protection IP2XB (all screens, shrouds and fuse handles in place)
- Equipped with BS 7657 100A rated SP outgoing ways (BS 88 30 x 57mm cylindrical cartridge fuses, not supplied)
- Serrated cable bores in 100A outgoing ways accept up to 35mm² solid or stranded conductors
- Neutral and Earth bars fitted with twin hexagon drive M8 cable pinching screws per terminal
- Termination kit for 4 core cable with 95mm² to 300mm² mechanical shear-off connectors specifiable at point of order
- Above terminals will accept solid aluminium or stranded copper conductors, Waveform or SWA type cables (additional kit required for each SWA termination)
- BS 88 J type slotted tag fuses with 92mm fixing centres fitted on incoming phases
- Fully rated Neutral and Earth bars

Construction

- Enclosure..... Zinc coated mild steel 1.2mm thick
- Busbars..... Electro-tin plated copper
- Terminal blocks Brass
- Terminal shields..... Transparent polycarbonate
- J type fuse holders Glass reinforced Polybutylene Terephthalate (PTB)
- J type fuse bases Glass reinforced polyamide 6

Performance Data

- Incoming supply630A Max
- Busbar rating630 A nominal
- Supply voltage 415V a.c.
- Frequency50-60Hz
- Rated insulation voltage.....690V a.c.
- Short circuit withstand strength 18kA for 1 second
- Operator protection
- All shrouds and fuse handles in place .. IP2XB
- Operational condition
 - All shrouds and fuse handles in place IP2XB
 - Operational condition, both doors closed...IP3X
- Recommended N/E bar terminal torque3.5Nm

Conformity to Standards

- Third party tested to BS EN 60439-1 (Form 4 compliant)
- Complies with draft ENA Technical Specifications for MSDBs
- IP rating according to BS EN 60529
- Incoming fusesBS 88 J type
- Outgoing fuse ways to BS 7657:1993

Weight (excluding fuses)

- 1J Ex works net weight53kgs
- 2 J Ex works net weight69kgs

J Enclosure (not to scale)

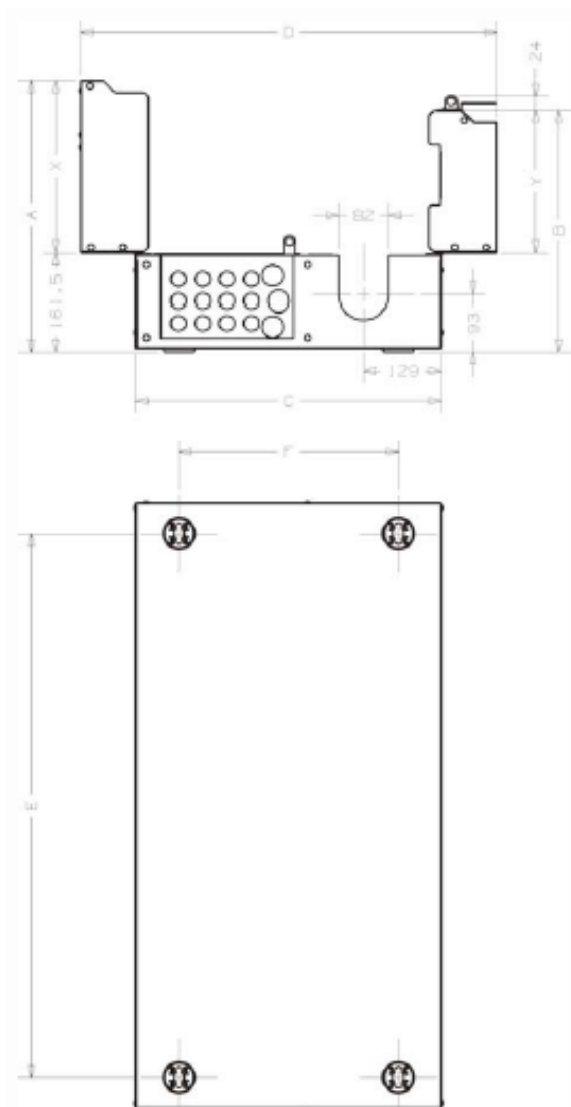

Height: 1000mm, Case closed depth: 248mm

Configuration	Dimensions in mm						Fixing centres	
	X	Y	C	D	A	B	E	F
15 way 2J	424	235	642	825	586	397	900	900

Disclaimer: Lucy Electric has a policy of continuous research and development thus accordingly reserves the right to change the design and specifications of its products without prior notice or liability.



www.lucyelectric.com

J Enclosure (not to scale)

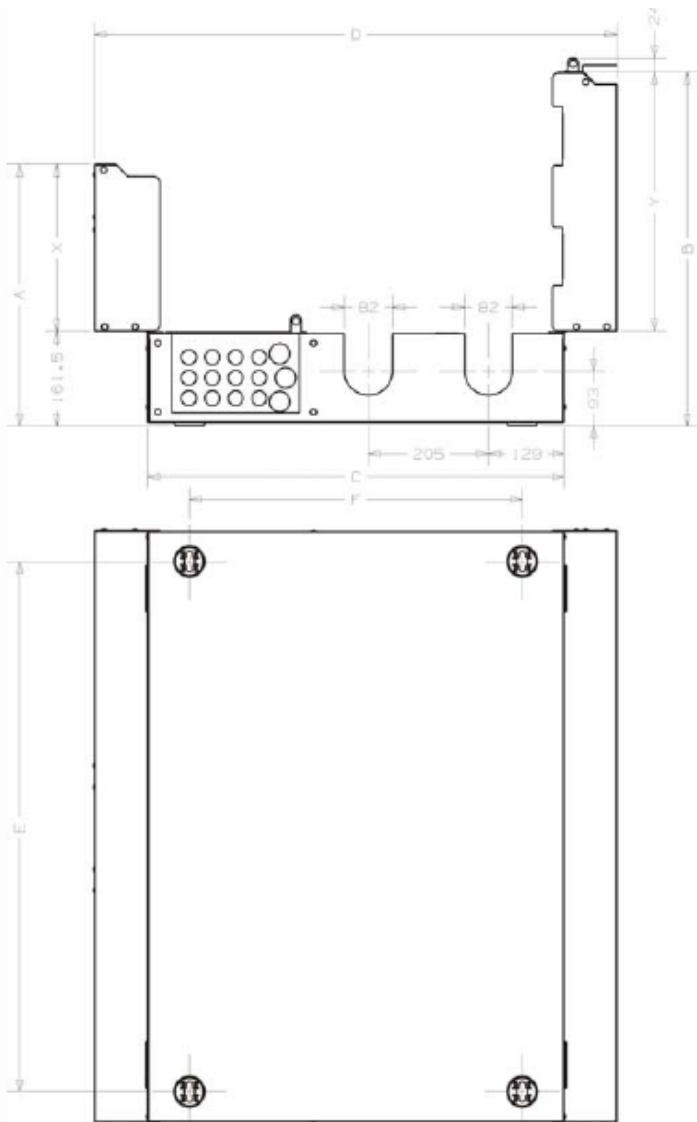

Height : 1000mm, Case closed depth: 248mm

Configuration	Dimensions in mm						Fixing centres	
	X	Y	C	D	A	B	E	F
15 way 2J	424	442	849	1032	586	604	900	661

Disclaimer: Lucy Electric has a policy of continuous research and development thus accordingly reserves the right to change the design and specifications of its products without prior notice or liability.



www.lucyelectric.com